



View system assembly: *General Overview (1:11):* <https://www.youtube.com/watch?v=Okes9-Haito>
Step-by-Step (4:08): <https://youtu.be/NVrEVDgH1N4>

TOOLS NEEDED

Hammer drills (recommend 120V, 60Hz)
 1/2" drill bits (for asphalt and/or concrete installation) Masonry bits (for concrete; see specific anchor specs for drill size) Hammer
 Impact wrenches and 3/4" socket (for installing anchors)

Socket wrench and socket set (including 7/16" wrench & socket)
 Socket extension, 4-6"
 1/2" Hex bit socket
 Tape measure
 Chalk line



Check with Public Works to confirm acceptable standards for anchoring temporary or permanent structures to roadway surfaces.

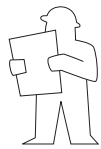

Refer to specific site plans to properly place the PEDRAIL™ system.

Before installation: For best results, use chalk or chalk line to mark all desired Rail locations (e.g., start/stop points, angles, positioning within buffer zone, etc.).

1

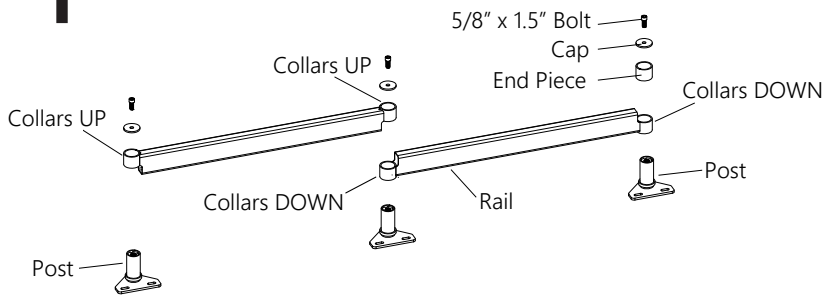

Familiarize yourself with the system components.

All Rails have **Collars** which can be oriented either in the **UP or DOWN** position.

2

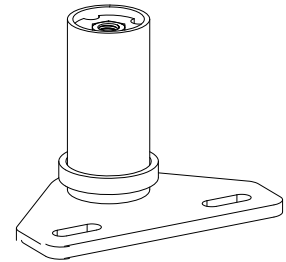

Set Posts down and space them to form the approximate configuration of the system.

Do not anchor Posts to the surface yet.

3

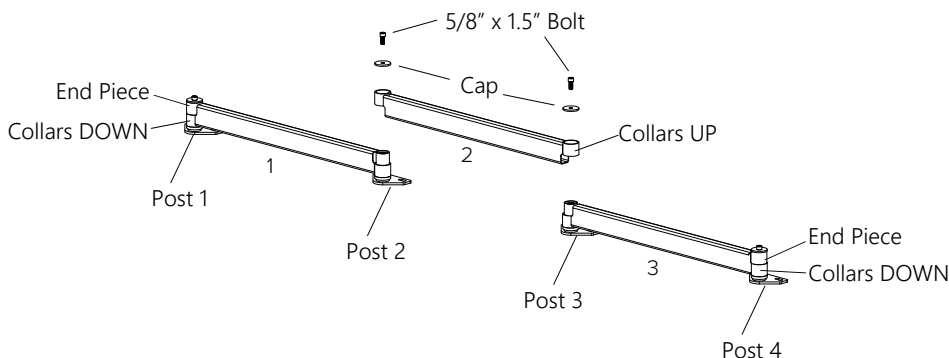

The Rails can now be attached to the Posts.

Slide the **first** Rail onto Posts #1 and #2 with Collars in the **DOWN** position.

Slide the **third** Rail onto Posts #3 and #4 with Collars in the **DOWN** position.

Repeat with all **odd-numbered Rails**: slide onto Posts with Collars **DOWN**.

Slide **second, fourth, sixth, and all even-numbered Rails** onto Posts with Collars in the **UP** position. This assembly creates hinges so each Rail swivels 180°.

